

INDUSTRIAL/WAREHOUSE  
FOR LEASE

# Pacific Business Park

12645 NE Marx St, Portland, OR 97230  
Building 12



## Key Features



5,017 sq. ft. shell



1,230 sq. ft. office



3 dock doors  
1 grade door

---

19' clear height

---

2.7 miles to PDX  
International Airport

---

Convenient access to  
Interstates 84 and 205

---

**Lease Rate (NNN):**

**\$0.90/sq. ft. shell**

**\$1.10/sq. ft. office**

**Jake Bigby**

jakeb@pactrust.com

**Caitlin Knecht**

caitlink@pactrust.com

503.624.6300

Owned & Managed by

**PACTRUST**

© 2024 PacTrust. All information supplied herein, including but not limited to measurements, dimensions, and specifications, is deemed reliable but is not guaranteed and should be independently verified. Any reliance on the information contained herein is at the user's own risk.

# Space Plan

12645 NE Marx St, Portland, OR 97230

5,017 Sq. Ft.

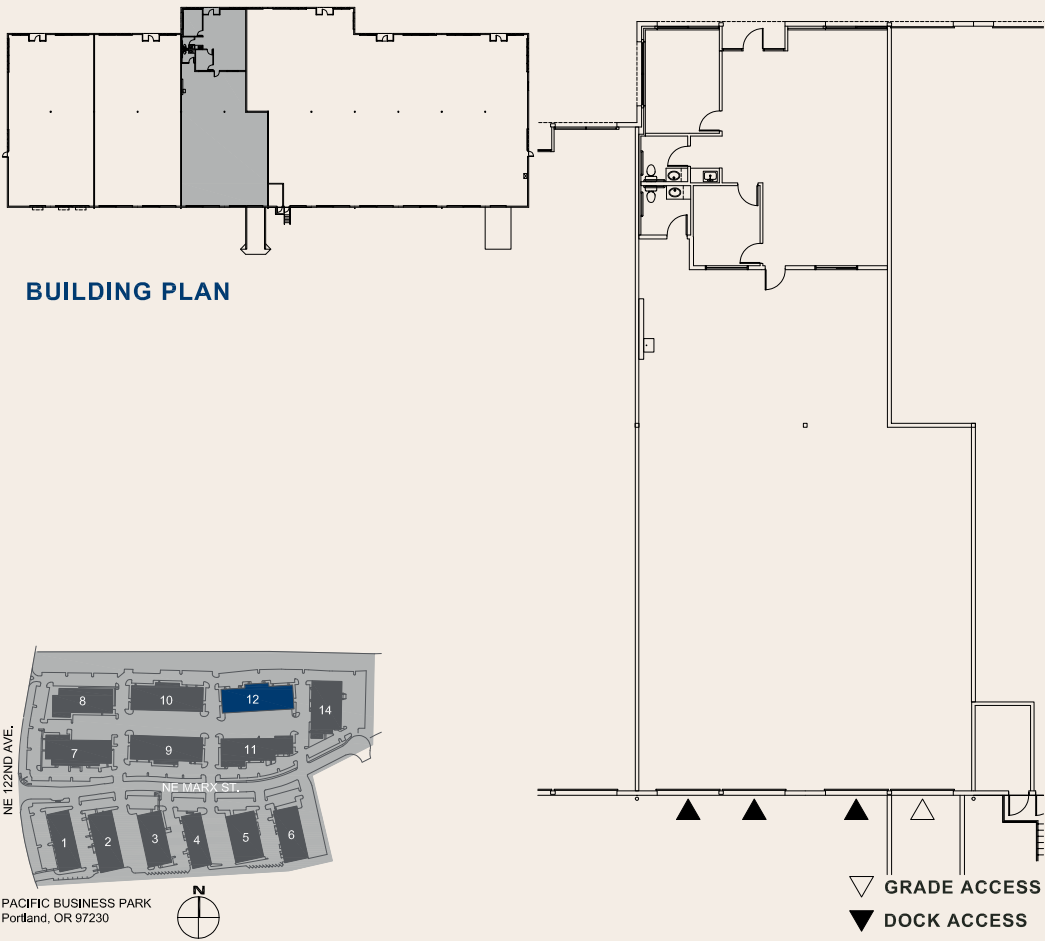

**Jake Bigby**  
jakeb@pactrust.com

**Caitlin Knecht**  
caitlink@pactrust.com

503.624.6300  
www.PacTrust.com